



Newsletter

28th April, 2008.

Labyrinth Up-Date

Great progress has been made! The Labyrinth has been planted and landscaped but will not open until nearer the summer.

The Multi-Faith art work is nearing completion with Year 6 and the Altrincham College of Arts.

To further bring our Woodheys families together in community cohesion, our pupils have realised the need for Global Peace and have chosen to have the symbols of peace at the centre of the Labyrinth. Our pupils will all write a prayer with their hopes and wishes for the future of Mother Earth. These will be hung in a 'prayer' tree by the side of the Labyrinth for the wind to carry their requests around the globe.

At the opening ceremony, we are hoping that local representatives or religious leaders from different faiths within our community will join us and walk the Labyrinth, to offer a prayer for Global Peace at the centre.

In January we hosted SACRE, Trafford's Religious Education forum, at the school. The Mayor of Trafford is a great admirer of our multi-faith work and subsequently accepting our invitation and attended our 'International Evening'. The Rev. Thomas Shepherd, the Chair of SACRE, wrote to thank Mrs Daniels for her presentation on the evening and to state that SACRE members were very impressed with all that is happening at the school to promote pupils' spiritual, moral, social and cultural development. Members could see that the celebrates its vibrant multicultural community and were particularly impressed with the environmental work and plans for the Labyrinth.

Different Faiths at Woodheys

Our religious education lessons cover all the major faiths and we are delighted that all our parents in school are happy for their children to have such an informed and broad knowledge of world religions.

We continue to have termly visits and assemblies from the Rev. Lorimar from the Methodist Church. His visit on the 20th March focused on the 'Easter Story'.

On March 11th Year 5 pupils walked to St. Mary's Church, where they undertook lots of craft activities and planting of bulbs, whilst learning about the Easter Story. All faiths are welcomed at the church.

The J.P. Joule Positive Energy Garden 2008
Installed by Nicholas J. Bolt and designed by the Woodheys Community
Funded by the Ashden Awards 2007

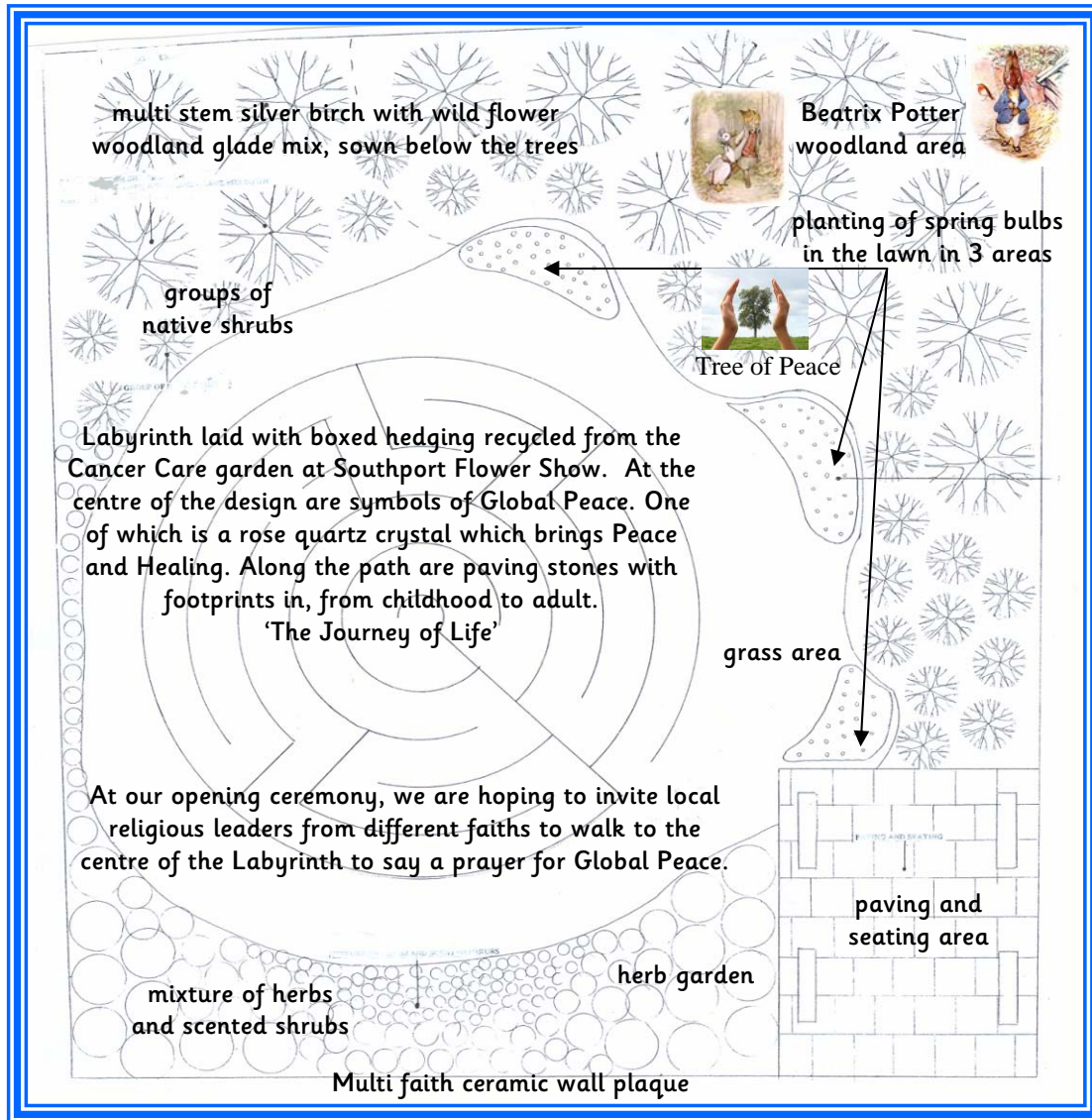

In 2007 we won first prize nationally for energy conservation in the Ashden Awards. Our prize of £15,000 was presented to us by Al Gore. We have pledged to use the money to further educate the Woodheys community about sustainability and to share our good practice nationally and internationally.

Prof. David Wards from SETPOINT, dresses in role as J.P. Joule and is working alongside our pupils in Year 5 and 6 on exciting science project days on Forces, Electricity and light. Around the garden there will be information points, telling the pupils about J.P. Joule and his scientific achievements linked to energy. Both inside and around the Labyrinth there will be solar powered water features, garden ornaments and lighting. Our herb garden will form part of our sensory trail, opposite the tactile art work displayed along the nursery wall. The herbs will be used in our school kitchen.

J.P. Joule lived in the Sale area for 17 years. The 'kilojoule' measurement of energy is named in his honour. At the centre of our Labyrinth, the children have suggested that we have symbols of 'peace'. The labyrinth is not a maze. There are no tricks to it and no dead ends. A maze is designed for you to lose yourself, a labyrinth is designed for you to find yourself. It has one circuitous path that meanders and winds into the centre. Pilgrims once used the experience of walking the labyrinth as a symbolic journey to Jerusalem. More recently the labyrinth is being used for healing, meditation and spiritual purposes. There is no right or wrong way to walk a labyrinth. Walk it with soft eyes, an open mind and an open heart.

Labyrinths are being built in schools throughout the world, painted on playgrounds, laid in stone in courtyards and outlined in flowers and bushes in gardens. Labyrinths engage a child's natural creativity. The garden will also provide a quiet place for the Woodheys community in our busy lives.

Please visit websites www.veriditas.org and www.labyrinthsociety.org

Our Labyrinth is designed for wheelchair access.

The gardens and tactile art work are designed for sensory impaired pupils and visitors.

Mrs L. Daniels

0161 973 4478 - e-mail: woodheys.ldaniels@traffordlearning.org